

## SS 6300 2RS - Stainless Steel Single Row Ball Bearings

Shaft Sizes from 4 mm up to 50 mm. Operating temperature range: -30°C to +110°C

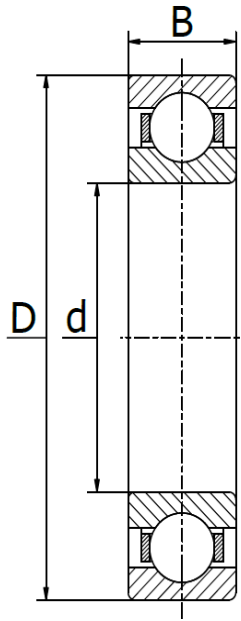

### Bearing inserts:

Inner & Outer Races: AISI 420-440 Stainless

Balls: AISI 420-440 Stainless

Cage: AISI 304

Seals: Rubber

Grease: Food Grade FDA & NSF approved

Part no.	Dimensions (mm)			Basic load Ratings (kN)		Limiting Speeds (RPM)		Weight (kg)
	d	D	B	Dynamic $C_r$	Static $C_{or}$	Grease	Oil	
SS 634 2RS	4	16	5	0,76	0,25	30.000	40.000	0,005
SS 635 2RS	5	19	6	2,34	0,88	24.000	36.000	0,008
SS 636 2RS	6	22	7	2,34	0,80	22.000	34.000	0,013
SS 637 2RS	7	26	9	3,97	1,96	24.000	32.000	0,024
SS 638 2RS	8	28	9	3,97	1,96	22.000	30.000	0,029
SS 639 2RS	9	30	10	4,94	2,32	20.000	26.000	0,035
SS 6300 2RS	10	35	11	7,30	3,00	17.000	21.000	0,050
SS 6301 2RS	10	37	12	8,70	3,70	16.000	20.000	0,060
SS 6302 2RS	15	42	13	10,30	4,70	13.000	18.000	0,080
SS 6303 2RS	17	47	14	12,00	5,90	11.000	17.000	0,110
SS 6304 2RS	20	52	15	14,40	7,00	11.000	15.000	0,140
SS 6305 2RS	25	62	17	20,10	10,10	8.000	13.000	0,220
SS 6306 2RS	30	72	19	27,00	15,10	6.700	10.000	0,350
SS 6307 2RS	35	80	21	30,10	17,40	6.000	8.000	0,454
SS 6308 2RS	40	90	23	39,40	23,10	5.300	7.200	0,639
SS 6309 2RS	45	100	25	48,00	28,00	4.800	6.200	0,836
SS 6310 2RS	50	110	27	56,00	34,00	4.300	5.500	1,082